

CHOWGULE AND COMPANY PRIVATE LIMITED, CHOWGULE HOUSE, MORMUGAO HARBOUR-GOA.
Geo Referenced Cadastral Map of Dhangarwado Xelpencho Sodo Mining Lease, bearing T.C. No. 31 of 1955, situated
in Xelopo-curado, Gavanem & Ambeli Villages of Satari Taluka, North Goa District, Goa State.

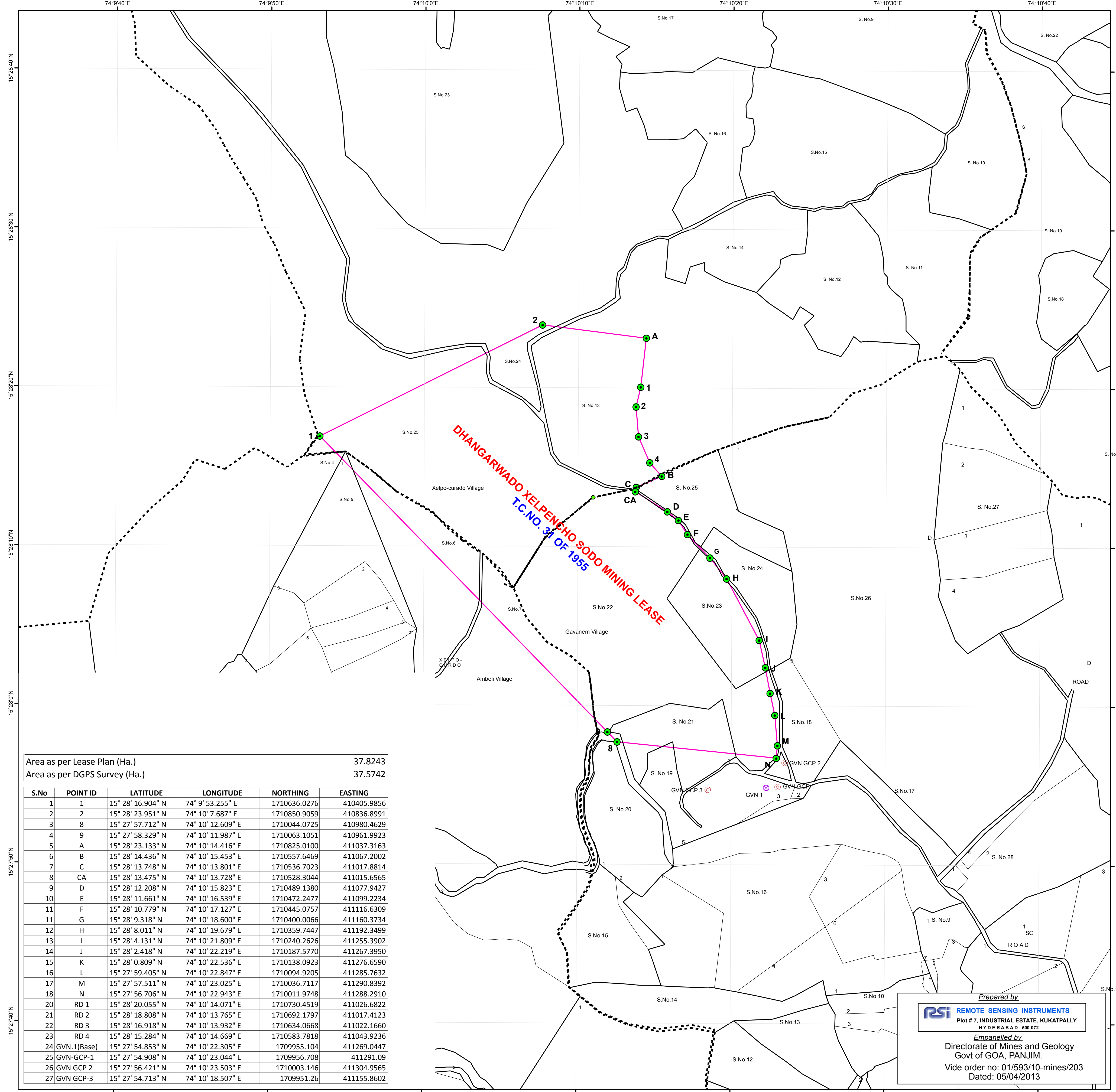

Area as per Lease Plan (Ha.)	37.8243
Area as per DGPS Survey (Ha.)	37.5742

S.No	POINT ID	LATITUDE	LONGITUDE	NORTHING	EASTING
1	1	15° 28' 16.904" N	74° 9' 53.255" E	1710636.0276	410405.9856
2	2	15° 28' 23.951" N	74° 10' 7.687" E	1710850.9059	410836.8991
3	8	15° 27' 57.712" N	74° 10' 12.609" E	1710044.0725	410980.4629
4	9	15° 27' 58.329" N	74° 10' 11.987" E	1710063.1051	410961.9923
5	A	15° 28' 23.133" N	74° 10' 14.416" E	1710825.0100	411037.3163
6	B	15° 28' 14.436" N	74° 10' 15.453" E	1710557.6469	411067.2002
7	C	15° 28' 13.748" N	74° 10' 13.801" E	1710536.7023	411017.8814
8	CA	15° 28' 13.475" N	74° 10' 13.728" E	1710528.3044	411015.6565
9	D	15° 28' 12.208" N	74° 10' 15.823" E	1710489.1380	411077.9427
10	E	15° 28' 11.661" N	74° 10' 16.539" E	1710472.2477	411099.2234
11	F	15° 28' 10.779" N	74° 10' 17.127" E	1710445.0757	411116.6309
12	G	15° 28' 9.318" N	74° 10' 18.600" E	1710400.0066	411160.3734
13	H	15° 28' 8.011" N	74° 10' 19.679" E	1710359.7447	411192.3499
14	I	15° 28' 4.131" N	74° 10' 21.809" E	1710240.2626	411255.3902
15	J	15° 28' 2.418" N	74° 10' 22.219" E	1710187.5770	411267.3950
16	K	15° 28' 0.809" N	74° 10' 22.536" E	1710138.0923	411276.6590
17	L	15° 27' 59.405" N	74° 10' 22.847" E	1710094.9205	411285.7632
18	M	15° 27' 57.511" N	74° 10' 23.025" E	1710036.7117	411290.8392
19	N	15° 27' 56.706" N	74° 10' 22.943" E	1710011.9748	411288.2910
20	RD 1	15° 28' 20.055" N	74° 10' 14.071" E	1710730.4519	411026.6822
21	RD 2	15° 28' 18.808" N	74° 10' 13.765" E	1710692.1797	411017.4123
22	RD 3	15° 28' 16.918" N	74° 10' 13.932" E	1710634.0668	411022.1660
23	RD 4	15° 28' 15.284" N	74° 10' 14.669" E	1710583.7818	411043.9236
24	GVN 1(Base)	15° 27' 54.853" N	74° 10' 22.305" E	1709955.104	411269.0447
25	GVN GCP-1	15° 27' 54.908" N	74° 10' 23.044" E	1709956.708	411291.09
26	GVN GCP-2	15° 27' 56.421" N	74° 10' 23.503" E	1710003.146	411304.9565
27	GVN GCP-3	15° 27' 54.713" N	74° 10' 18.507" E	1709951.26	411155.8602

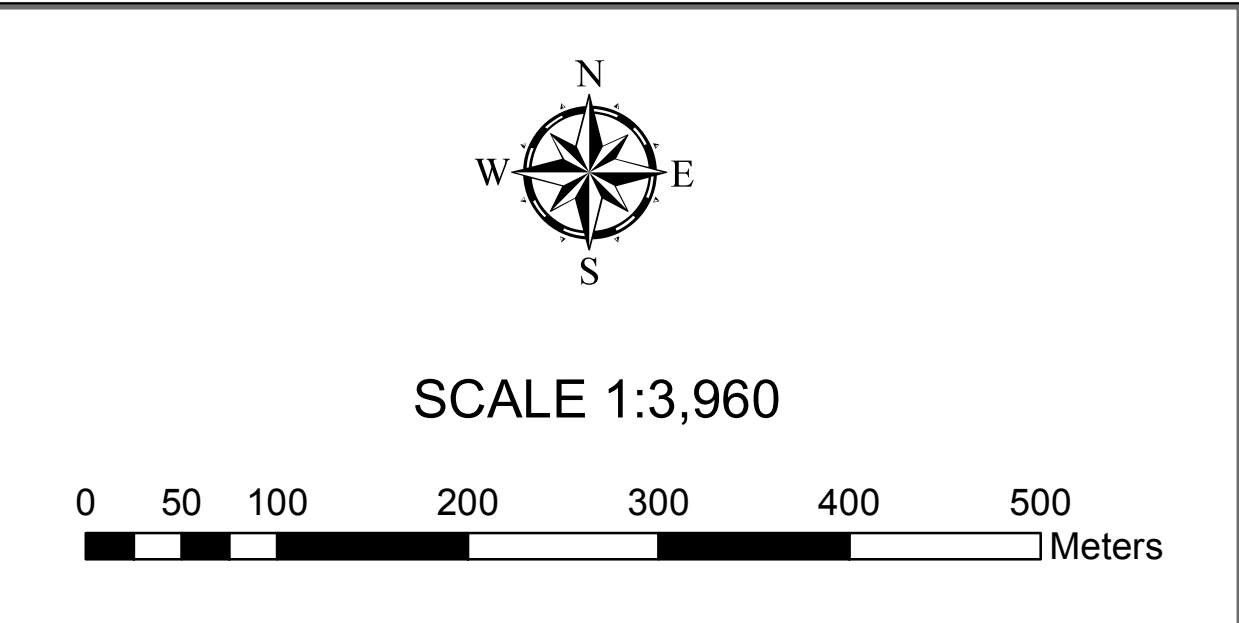

- Legend**
- DGPS POINT OF LEASE BOUNDARY
 - LEASE BOUNDARY AS PER DGPS SURVEY
 - SURVEY No BOUNDARY
 - SUB-DIVISION OF THE SURVEY No
 - - - VILLAGE BOUNDARY
 - ⊗ BASE STATION
 - ⊙ GROUND CONTROL POINTS

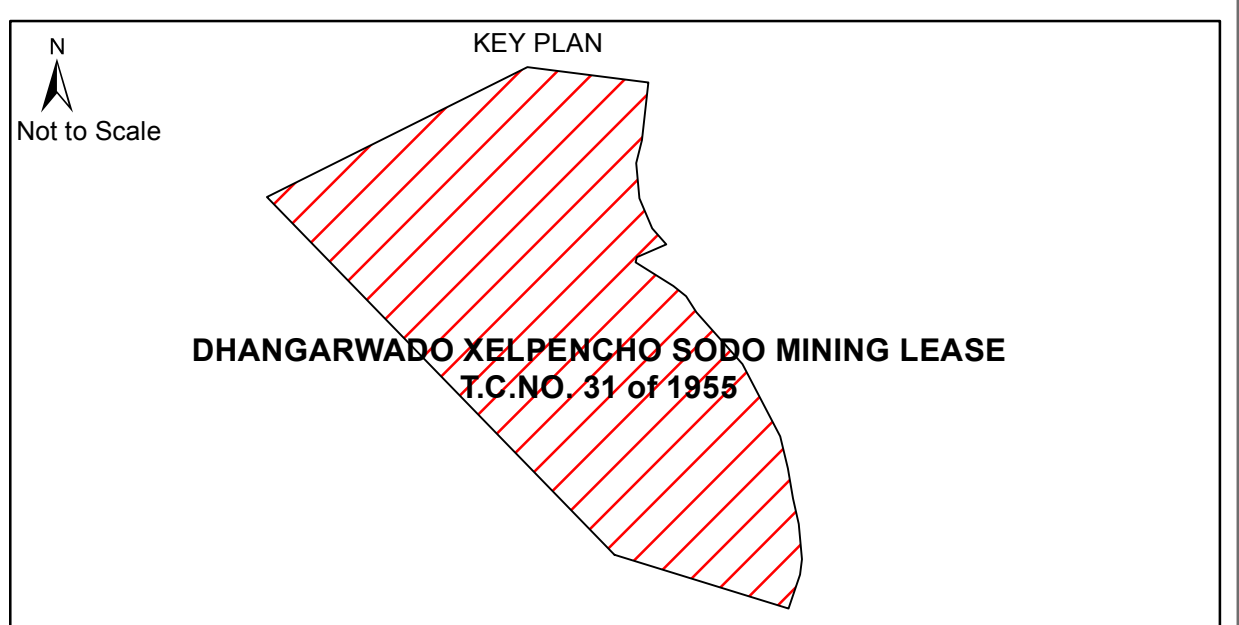

DATUM : WGS 84
 PROJECTION : UTM_Zone_43N

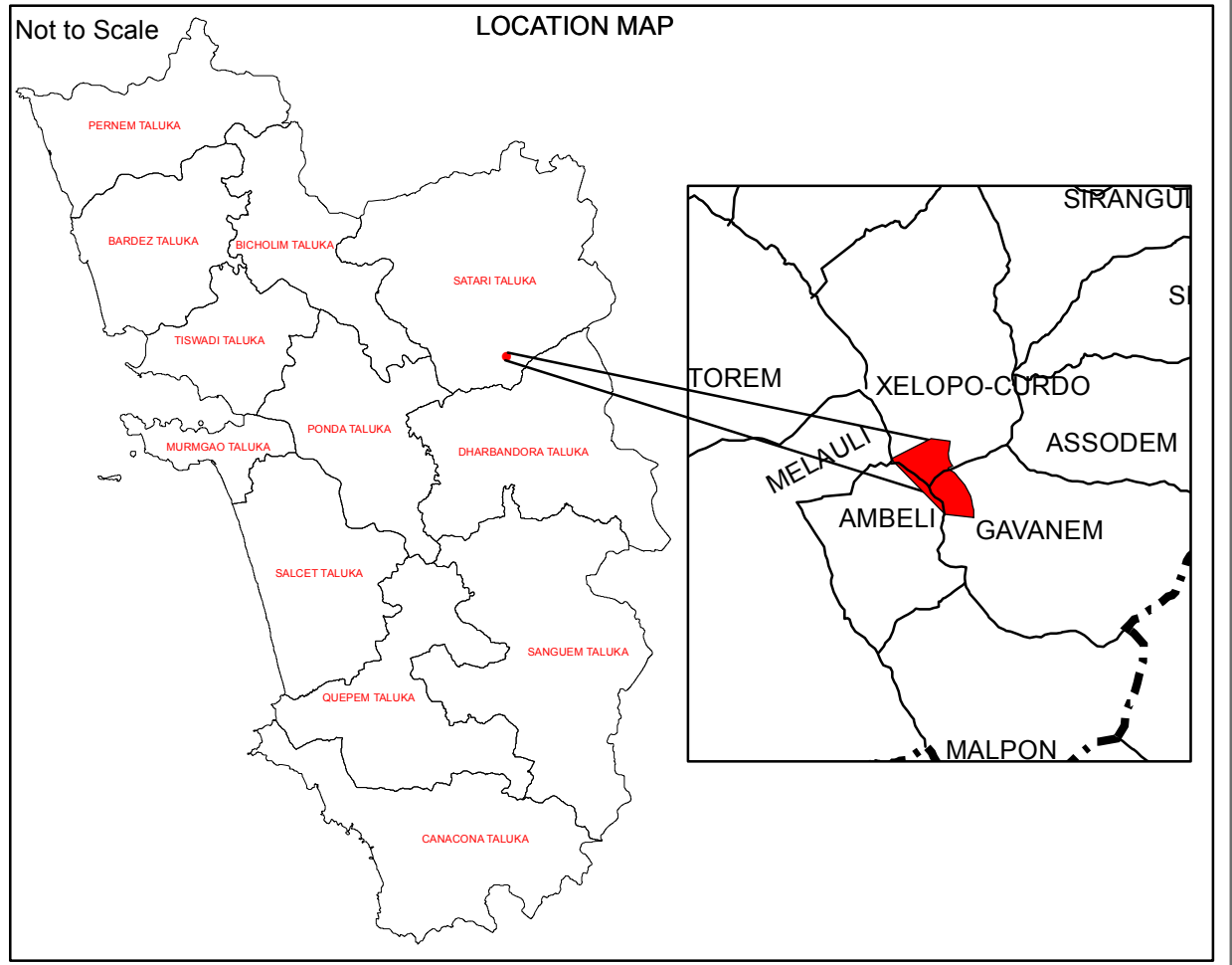

Certificate by Mines Manager

This is to certify that the lease boundary pillars of T.C. No. 31 of 1955 have been surveyed and fixed on the ground by using Total Station and the same are surveyed by using DGPS (Differential Global Positioning System).

Mr.D.V.PAWAR
(Mines Manager)

Certificate by Accredited Agency

This is to certify that the lease boundary pillars of T.C. No. 31 of 1955, shown by Mr.D.V.PAWAR (Mines Manager) has been surveyed by our team led by Shri.Ch Sivaiah using DGPS (Differential Global Positioning System) instruments. The lease map and pillar locations have been verified, survey conducted and plans prepared as per requirement of IBM circular No. 2/2010 dated 06-04-2010.

For Remote Sensing Instruments
Shri. B.V Ramana Kumar
(General Manager)

Prepared by
RSI REMOTE SENSING INSTRUMENTS
 Plot # 7, INDUSTRIAL ESTATE, KUKATPALLY
 HYDERABAD - 500 072
 Empanelled by
 Directorate of Mines and Geology
 Govt of GOA, PANJIM.
 Vide order no: 01/593/10-mines/203
 Dated: 05/04/2013

Directorate of Mines and Geology - Panaji -Goa	
Checked by	Certified by
Surveying officer	Director of Mines and Geology

Date of DGPS survey: 5th Jun, 2013