

Geo Referenced Cadastral Map of Orasso Dongor Mining Lease, bearing T.C. No. 76 of 1952, situated in Adwalpale Village of Bicholim Taluka and Moitem Village of Bardez Taluka, North Goa District, Goa State.

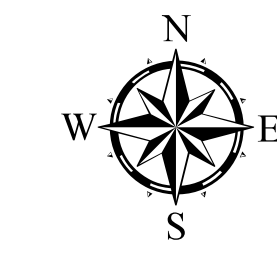

SCALE 1:3,960

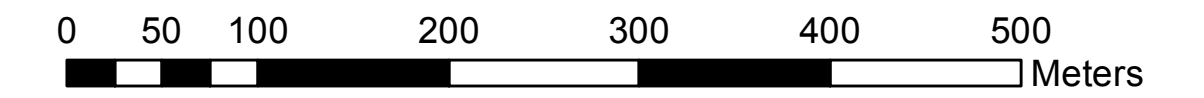

Legend

- DGPS POINT OF LEASE BOUNDARY
- LEASE BOUNDARY AS PER DGPS SURVEY
- ADJACENT LEASE BOUNDARY
- SURVEY No BOUNDARY
- SUB-DIVISION OF THE SURVEY No
- TALUKABOUNDARY
- VILLAGE BOUNDARY

KEY PLAN

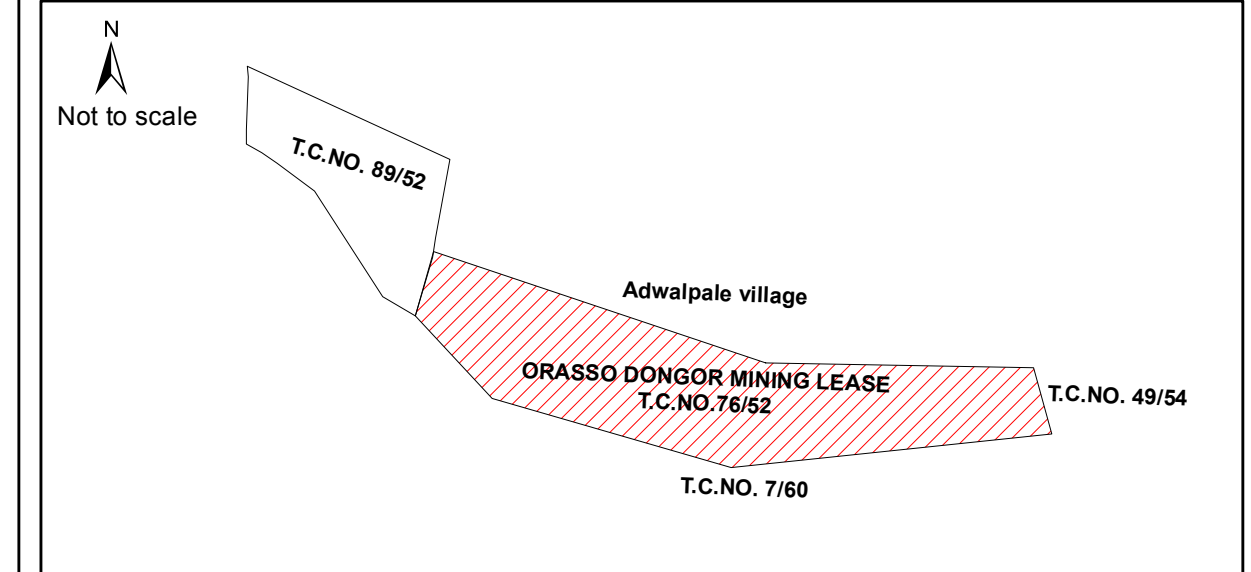

DATUM : WGS 84

PROJECTION : UTM_Zone_43N

LOCATION MAP

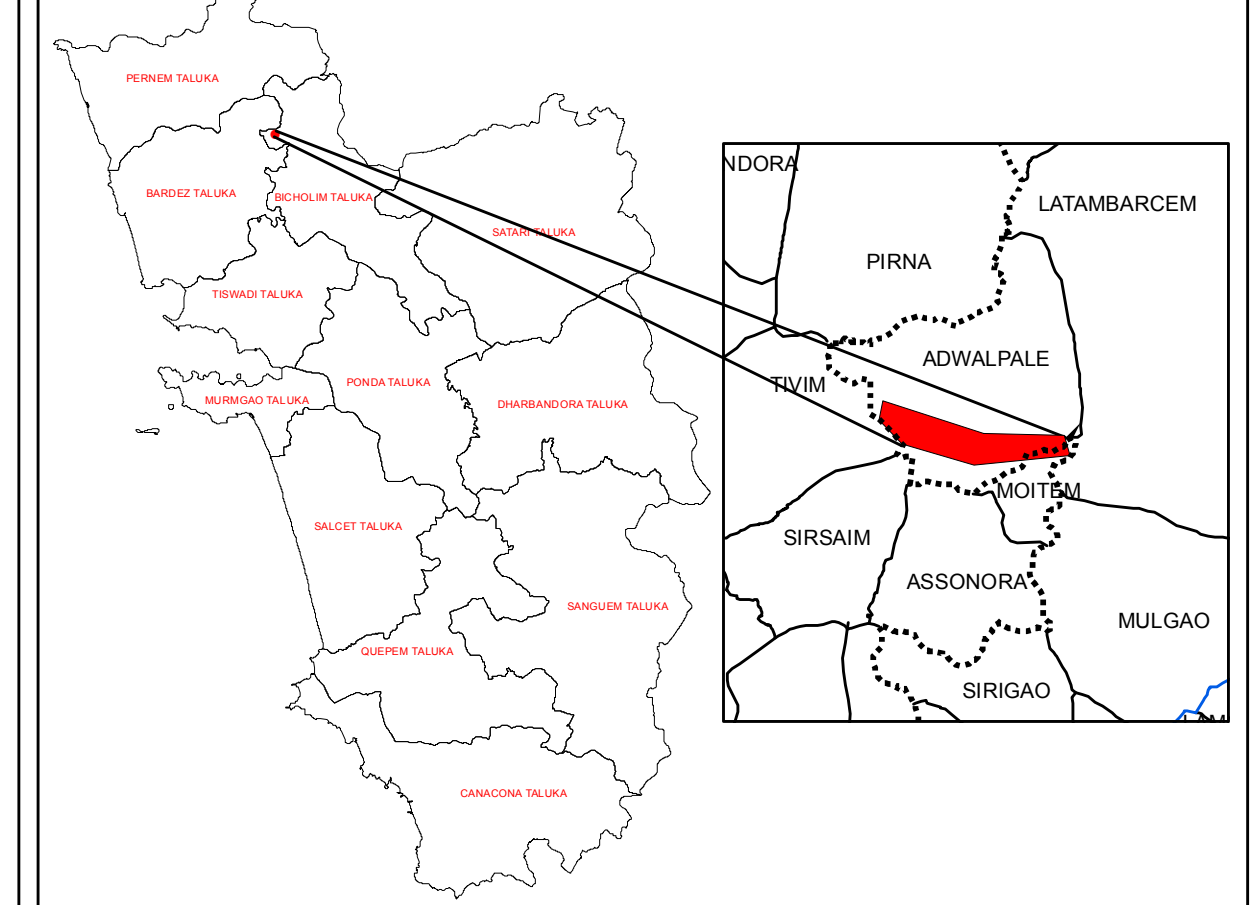

CERTIFICATE

This is to certify that the lease boundary pillars of T.C. No.76 of 1952 have been surveyed using DGPS (Differential Global Positioning System) and is based upon the Total Station survey conducted earlier.

Mr.Umesh Kadam
(Mines Manager)

CERTIFICATE

This is to certify that the lease boundary pillars of T.C. No. 76 of 1952, shown by Mr.Umesh Kadam (Mines Manager) has been surveyed by our team led by Shri. Sivaiah using DGPS (Differential Global Positioning System) instruments. The lease map and pillar locations have been verified, survey conducted and plans prepared as per requirement of IBM Circular No. 2/2010 dated 6-4-2010

For Remote Sensing Instruments

Shri. B.V Ramana Kumar
(General Manager)

Directorate of Mines and Geology - Panaji -Goa

Checked by

Certified by

Surveying officer

Director of Mines and Geology

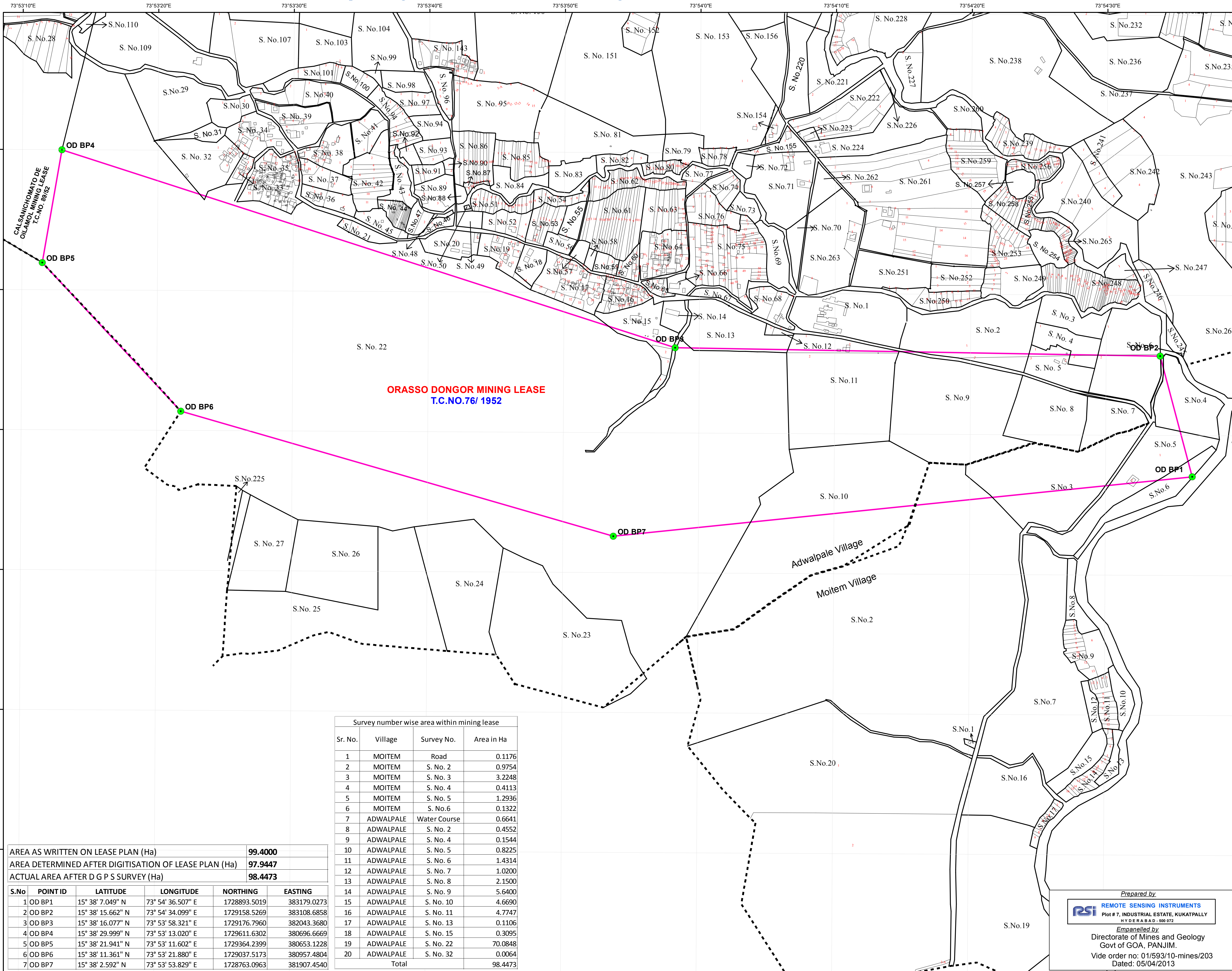

**ORASSO DONGOR MINING LEASE
T.C.NO.76/ 1952**

Survey number wise area within mining lease

Sr. No.	Village	Survey No.	Area in Ha
1	MOITEM	Road	0.1176
2	MOITEM	S. No. 2	0.9754
3	MOITEM	S. No. 3	3.2248
4	MOITEM	S. No. 4	0.4113
5	MOITEM	S. No. 5	1.2936
6	MOITEM	S. No. 6	0.1322
7	ADWALPALE	Water Course	0.6641
8	ADWALPALE	S. No. 2	0.4552
9	ADWALPALE	S. No. 4	0.1544
10	ADWALPALE	S. No. 5	0.8225
11	ADWALPALE	S. No. 6	1.4314
12	ADWALPALE	S. No. 7	1.0200
13	ADWALPALE	S. No. 8	2.1500
14	ADWALPALE	S. No. 9	5.6400
15	ADWALPALE	S. No. 10	4.6690
16	ADWALPALE	S. No. 11	4.7747
17	ADWALPALE	S. No. 13	0.1106
18	ADWALPALE	S. No. 15	0.3095
19	ADWALPALE	S. No. 22	70.0848
20	ADWALPALE	S. No. 32	0.0064
Total			98.4473

AREA AS WRITTEN ON LEASE PLAN (Ha)	99.4000
AREA DETERMINED AFTER DIGITISATION OF LEASE PLAN (Ha)	97.9447
ACTUAL AREA AFTER D G P S SURVEY (Ha)	98.4473

S.No	POINT ID	LATITUDE	LONGITUDE	NORTHING	EASTING
1	OD BP1	15° 38' 7.049" N	73° 54' 36.507" E	1728893.5019	383179.0273
2	OD BP2	15° 38' 15.662" N	73° 54' 34.099" E	1729158.5269	383108.6858
3	OD BP3	15° 38' 16.077" N	73° 53' 58.321" E	1729176.7960	382043.3680
4	OD BP4	15° 38' 29.999" N	73° 53' 13.020" E	1729611.6302	380696.6669
5	OD BP5	15° 38' 21.941" N	73° 53' 11.602" E	1729364.2399	380653.1228
6	OD BP6	15° 38' 11.361" N	73° 53' 21.880" E	1729037.5173	380957.4804
7	OD BP7	15° 38' 2.592" N	73° 53' 53.829" E	1728763.0963	381907.4540

Prepared by
RSI REMOTE SENSING INSTRUMENTS
Plot # 7, INDUSTRIAL ESTATE, KUKATPALLY
HYDERABAD - 508 072
Empanelled by
Directorate of Mines and Geology
Govt of GOA, PANJIM.
Vide order no. 01/593/10-mines/203
Dated: 05/04/2013

Date of DGPS survey : 21st May, 2013