

Geo Referenced Cadastral Map of Botvadeacho Dongor Mining Lease, bearing T.C. No. 28 of 1951, situated in Pissurlem Village of Sattari Taluka, North Goa District. Goa State

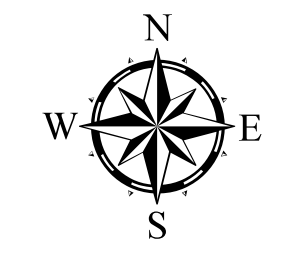

SCALE 1:3,960

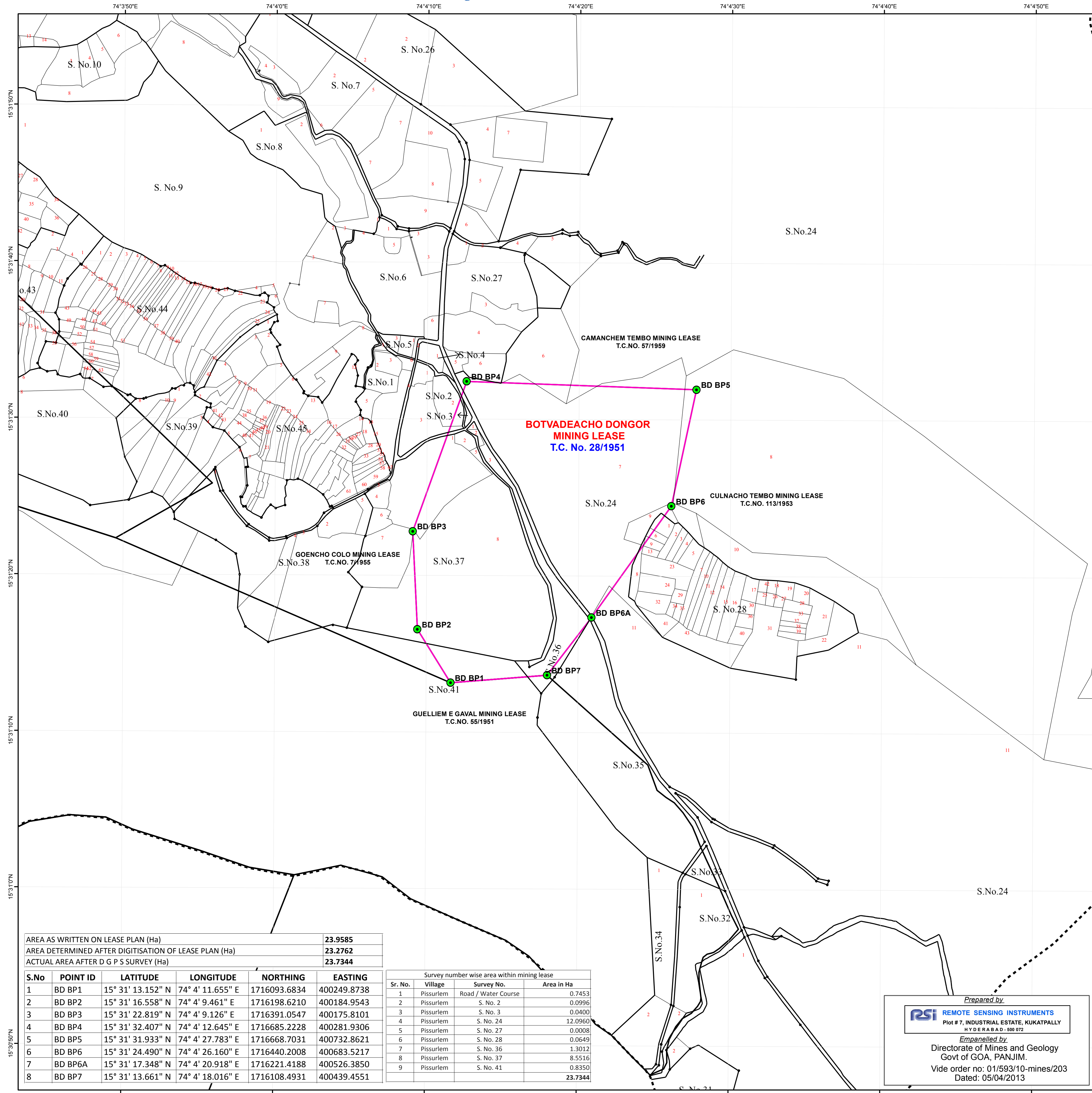
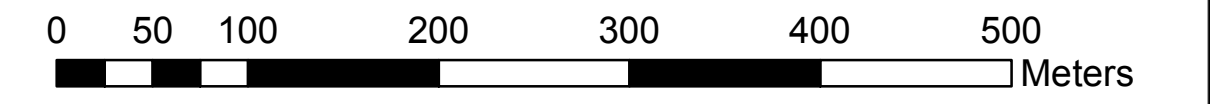

Legend

- DGPS POINT OF LEASE BOUNDARY
- ▭ LEASE BOUNDARY AS PER DGPS SURVEY
- ▭ ADJACENT LEASE BOUNDARY
- SURVEY No BOUNDARY
- SUB-DIVISION OF THE SURVEY No
- TALUKABOUNDARY
- VILLAGE BOUNDARY

KEY PLAN

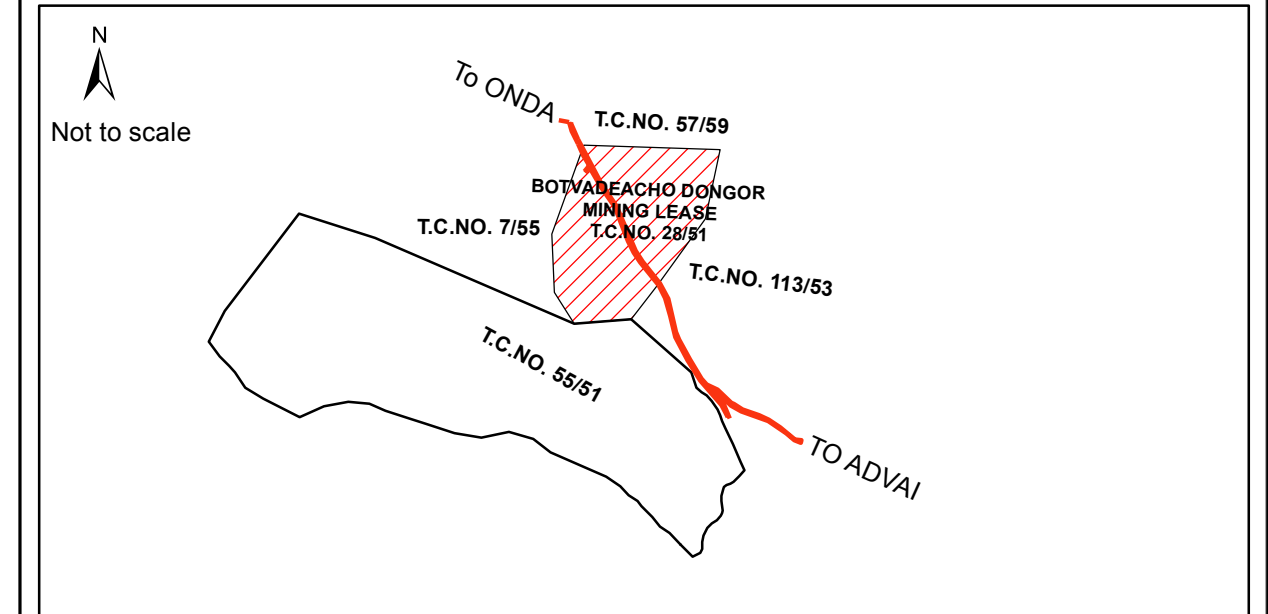

DATUM : WGS 84

PROJECTION : UTM_Zone_43N

LOCATION MAP

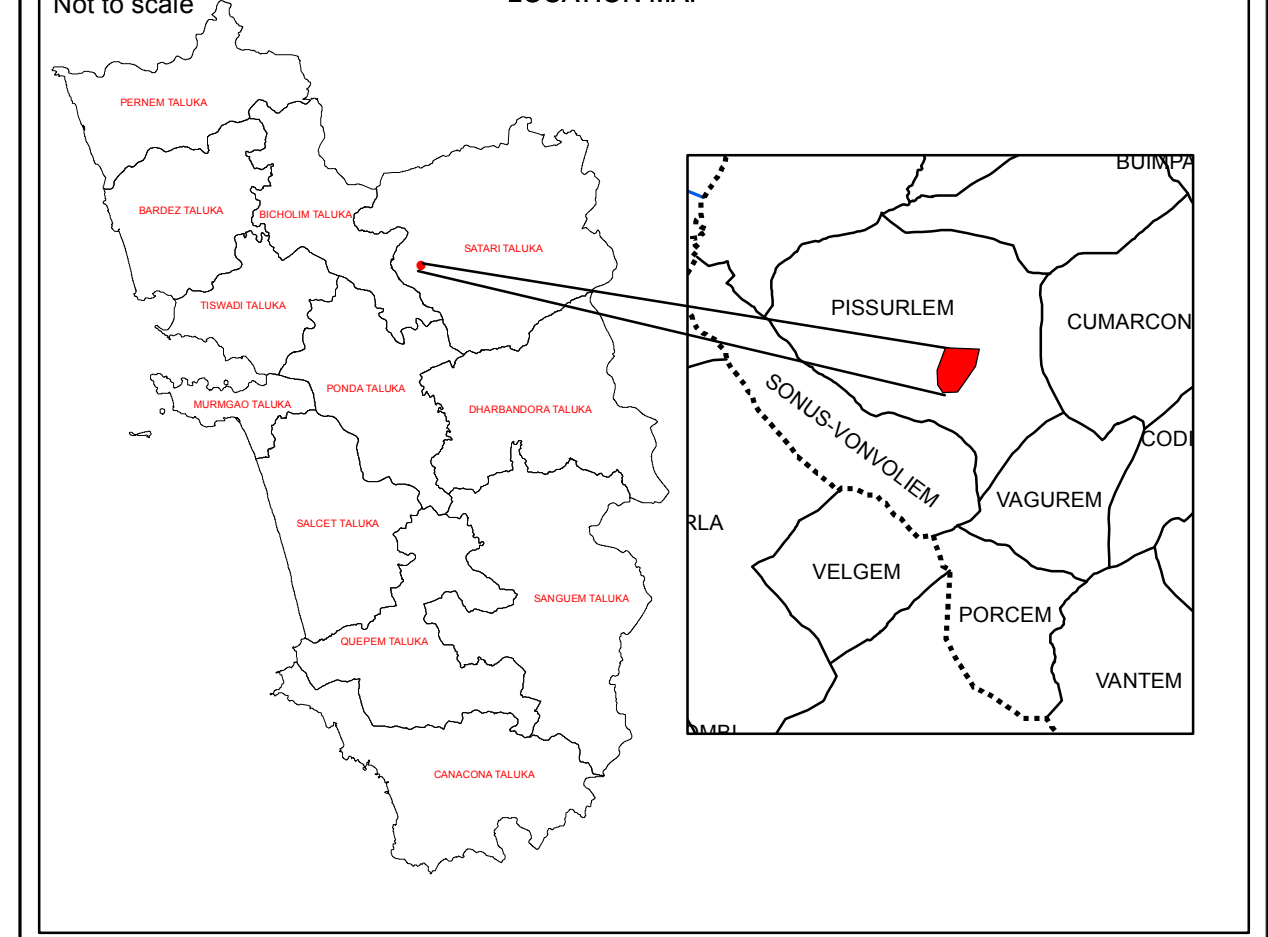

AREA AS WRITTEN ON LEASE PLAN (Ha)	23.9585
AREA DETERMINED AFTER DIGITISATION OF LEASE PLAN (Ha)	23.2762
ACTUAL AREA AFTER D G P S SURVEY (Ha)	23.7344

S.No	POINT ID	LATITUDE	LONGITUDE	NORTHING	EASTING
1	BD BP1	15° 31' 13.152" N	74° 4' 11.655" E	1716093.6834	400249.8738
2	BD BP2	15° 31' 16.558" N	74° 4' 9.461" E	1716198.6210	400184.9543
3	BD BP3	15° 31' 22.819" N	74° 4' 9.126" E	1716391.0547	400175.8101
4	BD BP4	15° 31' 32.407" N	74° 4' 12.645" E	1716685.2228	400281.9306
5	BD BP5	15° 31' 31.933" N	74° 4' 27.783" E	1716668.7031	400732.8621
6	BD BP6	15° 31' 24.490" N	74° 4' 26.160" E	1716440.2008	400683.5217
7	BD BP6A	15° 31' 17.348" N	74° 4' 20.918" E	1716221.4188	400526.3850
8	BD BP7	15° 31' 13.661" N	74° 4' 18.016" E	1716108.4931	400439.4551

Survey number wise area within mining lease			
Sr. No.	Village	Survey No.	Area in Ha
1	Pissurlem	Road / Water Course	0.7453
2	Pissurlem	S. No. 2	0.0996
3	Pissurlem	S. No. 3	0.0400
4	Pissurlem	S. No. 24	12.0960
5	Pissurlem	S. No. 27	0.0008
6	Pissurlem	S. No. 28	0.0649
7	Pissurlem	S. No. 36	1.3012
8	Pissurlem	S. No. 37	8.5516
9	Pissurlem	S. No. 41	0.8350
			23.7344

Prepared by
RSI REMOTE SENSING INSTRUMENTS
 Plot # 7, INDUSTRIAL ESTATE, KUKATPALLY
 HYDERABAD - 500 072
 Empanelled by
 Directorate of Mines and Geology
 Govt of GOA, PANJIM.
 Vide order no: 01/593/10-mines/203
 Dated: 05/04/2013

Date of DGPS survey : 18th May, 2013

CERTIFICATE
 This is to certify that the lease boundary pillars of T.C. No.28 of 1951 have been surveyed using DGPS (Differential Global Positioning System) and is based upon the Total Station survey conducted earlier.

Mr. Vikil Kawale
(Mines Manager)

CERTIFICATE
 This is to certify that the lease boundary pillars of T.C. No. 28 of 1951, shown by Mr. Vikil Kawale(Mines Manager) has been surveyed by our team led by Shri. Ch.Sivaiah using DGPS (Differential Global Positioning System) instruments. The lease map and pillar locations have been verified, survey conducted and plans prepared as per requirement of IBM Circular No. 2/2010 dated 6-4-2010.
 For Remote Sensing Instruments

Shri. B.V Ramana Kumar
(General Manager)

Directorate of Mines and Geology - Panaji -Goa	
Checked by	Certified by
_____ Surveying officer	_____ Director of Mines and Geology